

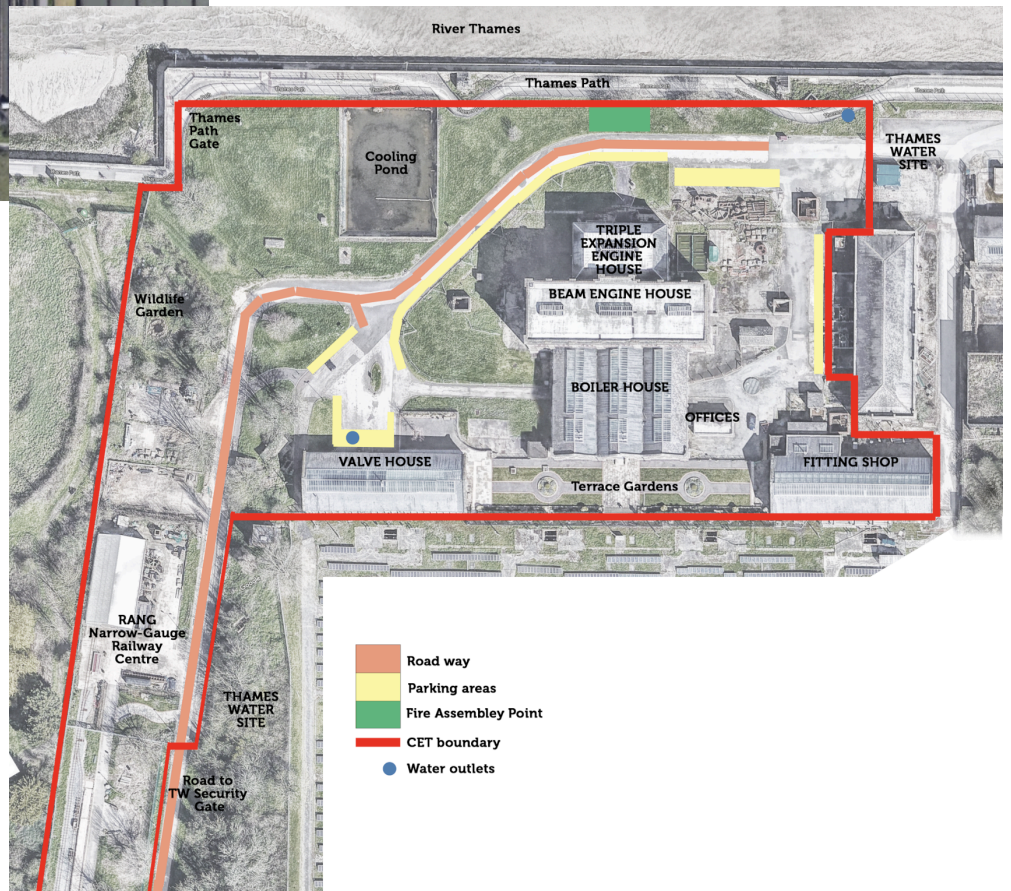

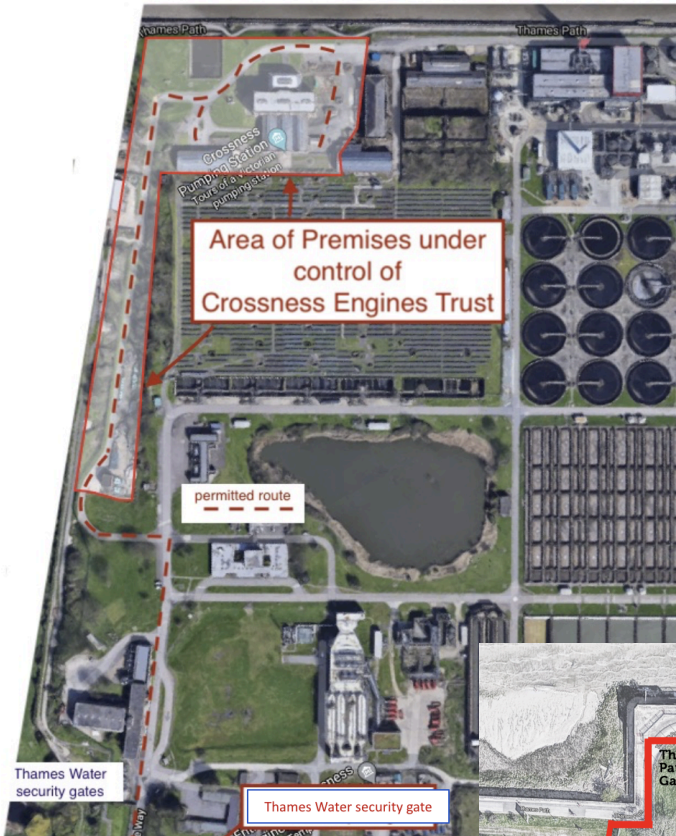







Crossness Engines Trust
 Thames Water Sewage Treatment Works
 Bazalgette Way
 London
 SE2 9AQ

The Crossness Engines Trust is a charity run by a group of volunteers and relies upon revenue from filming, events and photoshoots to maintain this wonderful building.



SITE INFORMATION

	<ul style="list-style-type: none"> • The main complex of buildings at Crossness are Grade I listed. • Preparation/set dressing must not result in any permanent change to the building • No drilling holes, nailing, sticky tape, fixings of any kind are permitted and no painting
	<ul style="list-style-type: none"> • The upper floors are grated so not good for those with vertigo or pointed heels. • The basement is small and cramped. • We need to give names of persons entering the site at least 24 hours prior to access. • Strictly no wandering allowed on Thames Waters land. See site map for routes.
	<ul style="list-style-type: none"> • CET is situated wholly within Thames Water Sewage Treatment Works which is a lower tier Control of Major Accident Hazards site. There are strict H&S protocols to abide by. Certain areas have access restrictions including asbestos and noxious gases. Clients using these areas will need to show what provisions they are putting in place. • If an alarm is sounded, crew are to remain inside buildings unless the risk is inside then they should leave the site immediately and muster in the car park outside the gates. • Hard hats must be worn when in the Beam Engine House as the floor is pierced and items can fall through and injure those below.

	<ul style="list-style-type: none"> • The lighting within CET is rudimentary at best and there is no emergency lighting. • It is recommended that Production bring its own electricity supply for powering film lights. • On site there is 13 amp + 32 amp + 63 amp single supply on site see map for locations. • All cables must be ramped or matted to ensure safe passage.
	<ul style="list-style-type: none"> • The display units can be moved to provide space for seating up to 150 people. A small charge will be made to remove and replace furniture. • The Educational Suite has space for 40 people sitting. • There is a male, female and disabled toilet unit in the Display area. Production to leave clean and supply toilet paper. • Water tap in café area and toilets • Mains water outside by the valve house • Frequent hand washing should be encouraged and especially before eating as there can be airborne particles present.
	<ul style="list-style-type: none"> • WIFI Is available on site for a small charge. • The Educational Suite has an overhead projector, laptop and sound system via HMI link.
	<ul style="list-style-type: none"> • The food preparation/café area in the Boiler House can be used. • Hot water urns are available. • Production may bring in its own catering. Cooking allowed on site.

	<ul style="list-style-type: none"> • Leave the site clean and tidy or a charge will be made for cleaning • Rubbish should be removed daily organised and paid by the production • Any signage needs removing upon departure or a cost applied.
---	---

First floor beam engine house

CROSSNESS ENGINES TRUST First Floor

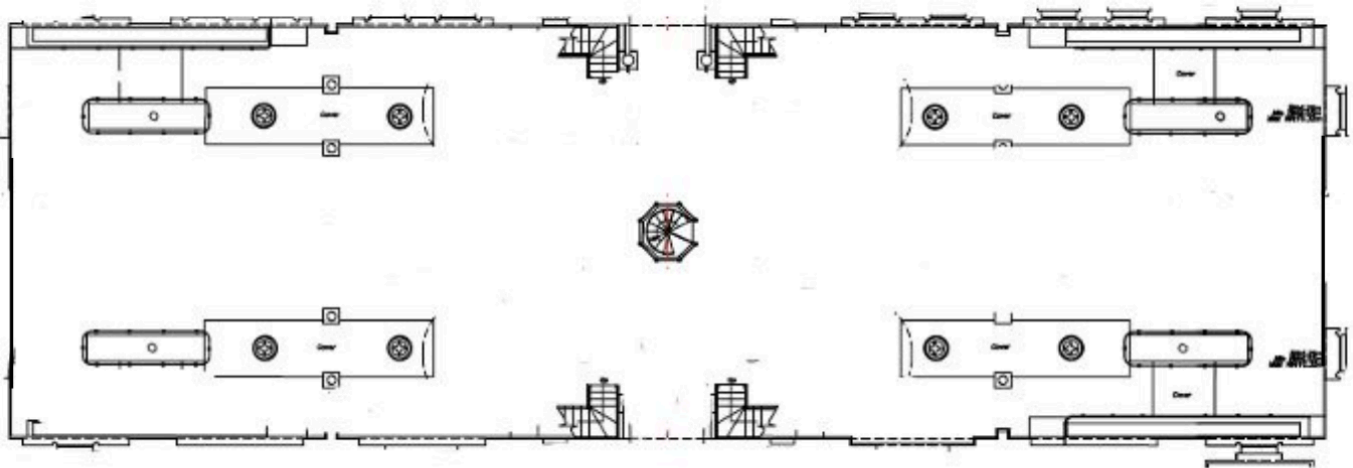

Beam Engine House